

**Relationship with Water**



**Background Information**

Christchurch residents have been unsettled by ongoing earthquakes and they need somewhere to relax. *This design brings tranquility back into everyday life by creating a peaceful escape within the city.*

The design is based on the idea of tranquility with the inspiration coming from the philosophical, spiritual and cultural traditions of North and West Asia to create a space that *instills a sense of peace and calm* to those who visit.

North and West Asia is a diverse region consisting of large mountains, glaciers, rivers, rain forests, deserts, small villages and highly populated cities. The region is a combination of coastal and land locked countries with water being a scarce and important resource. The climate varies widely from tropical monsoon in the South to temperate in the North. Hindu, Islam and Buddhism are practiced along with a wide variety of other religions. Stories and symbolism underpin many traditions and aspects of everyday life.

The design draws on a number of these characteristics to introduce a layer of meaning within the site that is particular to this region while remaining a place that is *welcoming and restful to all cultures and backgrounds.*

There is a strong focus on *sustainability* in the design in an attempt to reuse materials in a city that is generating large amounts of waste through the demolition of earthquake damaged buildings. The proposed site for this design is along the Avon River. The garden will initially be created in a temporary location with the intention to relocate it to a proposed "Tranquility Walk" in the Avon – Otakaro River Park.



**Connection to the Mountains**



**Connection to the Forest**



**Courtyard Gardens**



**Culture**



**Festivals**



**New Zealand Connections**





## The Design - A Place to Relax!

The garden is a tranquil space where people from a range of cultures can have some respite from the stress of the 2010 and 2011 earthquakes. The design was inspired by North & West Asia.

The design creates a progression from communal gathering spaces at the north end of the site through to increasingly smaller, quieter spaces at the south end of the site.

On first entering the garden the visitor is drawn in through a tunnel of lights. These lights are strung between pillars and across the roof of the pergola. To the right are two long tables to accommodate both large and small gatherings, straight ahead is the pergola and to the left are steps leading down into the river.

On walking through the pergola the visitor emerges into a hilly terrain planted in New Zealand native bush. The planting follows the curvature of the landscape to create tranquil nooks. From here you can look out across the river while listening to the soothing music of the native birds that are nesting in the trees.

## The Inspiration - North & West Asia

The layout is derived from a spiritual belief within the region with the key theme of the site being water. The theme reflects the significance of this resource to the region of North & West Asia and the calming and relaxing qualities of water.

The layers within the site echo the stepped ponds and wells of the region and the shapes and patterns of these layers are based on some of the region's major rivers.

The east side of the site is bordered by the Avon River which can be seen from all locations within the garden. On the bank of the river are long steps leading down into the water.

At the far south-west corner of the site there are a series of undulating pillars which follow the fence line. These pillars represent both the mountains and underlying traditions of the region and are decorated at the top and the bottom with mosaics made out of broken china or tiles (see image 3). The pillars at the entrance are also decorated and are of uniform height.

The entranceway reflects the often narrow streets and alleyways and the lights were inspired by a regional festival. The pergola is reminiscent of a courtyard often found in the North & West Asia architecture.

There is a fence along the west and south sides of the site. The fence is made of bamboo to keep a natural look to the site and to prevent the fence from becoming overbearing. Natural materials have been used wherever possible on the site.



1. Lights at the entrance to the garden. Trees outside the site will provide protection from the north-east wind.

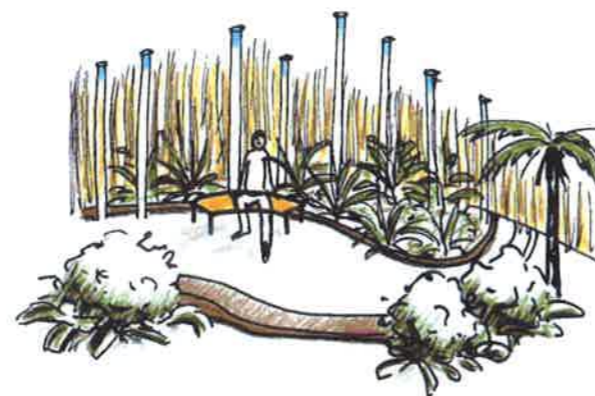

2. Seating in a nook at the top of the site.



3. Detail of pillars. Blue at the top represents the sky and brown at the bottom represents the earth.

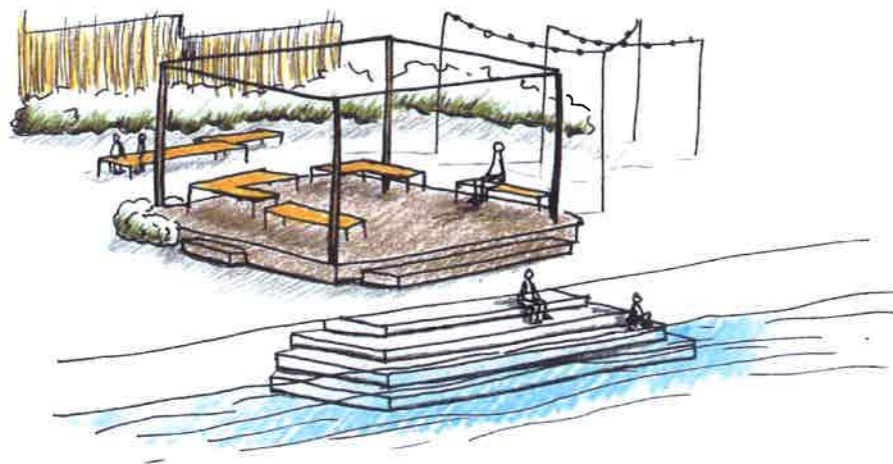

4. Looking into the site from the opposite bank.

Lights & entrance from the street

Low growing native shrubs & ferns

Tables

Finely crushed concrete and brick

Pergola

Seating in one of the nooks

Wooden edging to levels which double as seating

Steps down to Avon river

Native trees, shrubs & ferns

Posts representing mountains

Bamboo fence

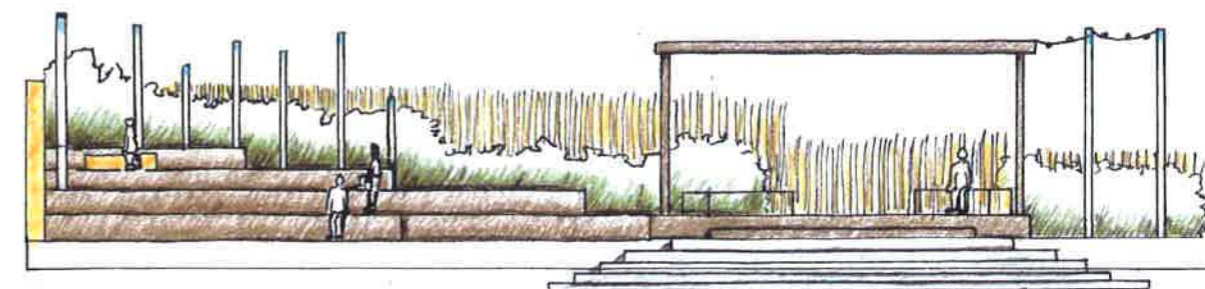

5-5. Section elevation showing level changes in the site.